

# 2000nm High Power 3-port Optical Circulator



www.AINNOTECH.com  
 Email: korea@ainnotech.com  
 TEL: 02,409,3222 FAX: 02,409,3229  
 서울시 송파구 가락동 10-9 한성 B/D 2F



## FEATURES

- High Isolation
- Low Insertion Loss
- Epoxy-Free Optical Path
- High Reliability and Stability
- Low Profile Packaging

## APPLICATIONS

- Fiber Optic Amplifiers
- Fiber Optic Instruments
- WDM Systems
- Dispersion Compensation
- Light Routing

## SPECIFICATIONS

Parameter	Unit	Value	
Center Wavelength ( $\lambda_c$ )	nm	2000	
Bandwidth	nm	+/-30	
Insertion Loss@23°C	(Typ.)	dB	1.3
	(Max.)	dB	1.8
Isolation@23°C	(Typ.)	dB	20
	(Min.)	dB	16
PDL	dB	≤0.2	
Optical Return Loss	dB	≥45	
Cross Talk	dB	≥40	
Fiber Type	-	SMF-28 Fiber or SM1950 Fiber (V) 10/130um DC Fiber (O) or 25/250um DC Fiber (R)	
Fiber Tensile Load	N	5	
Maximum Optical Power (CW)	W	1, 2, 3, 5, 10	
Operating Temperature	°C	0~50	
Storage Temperature	°C	-40~85	

- Note:**
- Specifications are for device without connectors; Specifications may change without notice.
  - To add connectors, IL is 0.3dB higher, RL is 5dB lower.
  - Only guarantee 1W continuous wave (CW) power thru testing for connectors added.
  - Devices for higher optical power or with other type fiber or consigned fiber are also available; Devices can only work in the core of Double Cladding (DC) Fiber, Cladding Power must be stripped before connecting the device.

## PACKAGE DIMENSION

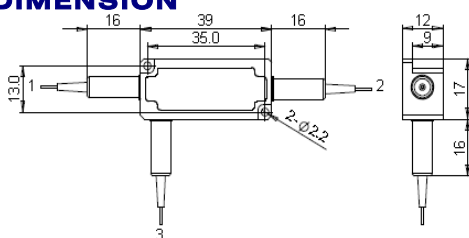

≤5W

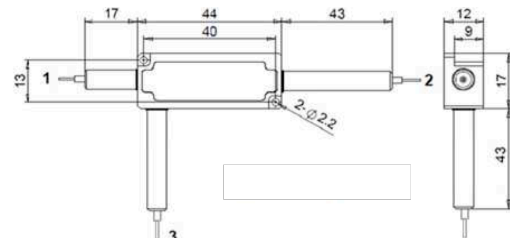

5~10W

## ORDERING INFORMATION (PN)

FCIR- <b>NNNN</b> -3HP <b>NN</b> - (C)	<b>C</b>	<b>NN</b>	-CC/CCC
Center Wavelength	Fiber Sleeve	Fiber Length	Connector Type
2000-2000nm	B= Bare fiber	05=0.5m	N=Without Connector
Optical Power	L= Loose Tube	10=1.0m	FC/APC=FC/APC Connector
1= 1W	2= 2mm Cable	15=1.5m	LC/PC=LC/PC Connector
3= 3W	3= 3mm Cable	20=2.0m	SC/UPC=SC/UPC Connector
5= 5W			
10= 10W			
Fiber Type			
V=SM1950 Fiber			
O=10/130 DC Fiber			
R=25/250 DC Fiber			
Blank for SMF-28 Fiber			